

Smart Flow Technology “Dual Valve Lubricator”

Definitive Optimization’s Dual Valve assembly “Inclusive Modular” design focuses on reducing the extensive cost of facility modification to accommodate the installation of a plunger lift lubricator. While ensuring functional & efficient operation of the plunger lift equipment.

Ease of Installation

- Easily reconfigured to fit in the spacing between a standard API flow tee and wing valve or API flow block and wing valve with a few easy adjustments.
- eliminates expensive highline modifications, as build field and engineering costs and extended down time.

Superior Lubricator Body Design

- Available in both 2 3/8 and 2 7/8, 5000 PSI WP.
- L80 Grade 4140 Cold Temp (-50 C) rated
- Fully Nace Compliant components
- Tensile strength range of 92000-98000 lbs per sq inch
- Every weld is stress relieved, 100% X-Rayed, and pressure tested to 7500 psi.

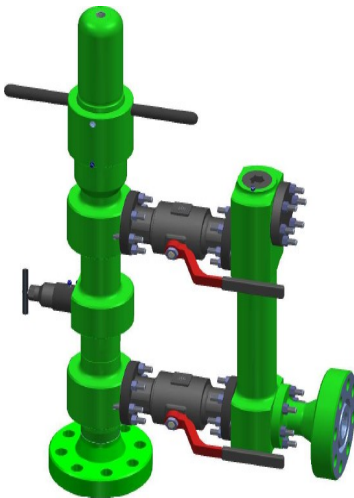

Flow Tee Replacement
Configuration

Impeccable Bowen Union and Spring Design

- With our superior spring and body design we have focused on the goal of achieving the highest rated Kinetic Energy rating in the Industry.
- Lubricator maintains the impeccable safety rating design our customers are accustomed to.
- Top Spring is rated for a maximum load of 6300 Newtons of Energy, or for example it will dissipate the KE in a 10 lb plunger (4.5 kg) travelling up to a maximum speed of 3125 meters per minute.

Highest Quality Valves and Bypass

- 6K Valve Assemblies are function tested to 1.5 times Working Pressure.
- Adjust the Bypass to match either an API Flow Block or Flow Tee height with minimal effort.
- The assembly uses steel face seals and is not reliant on soft material to maintain the pressure integrity on either side of the valves.



Flow Block Replacement
Configuration

The Smart Flow "wing Valve" design allows the operator to adjust the wing valve handle position around the Horizontal plain. This will accommodate a left or right-hand access to the handles and to match with the existing wellhead configuration. This allows the smart flow lubricator design universal and is not dependent on the Master valve positions and outlet line directions. With a simple adjustment it can be made to fit any configuration.

The lubricator and bypass components are made of high tensile strength, low temperature rated, NACE compliant material. The L80 Grade 4140 material tensile strength ranges from 92,000 to 98,000 Lbs per sq. Inch and are far superior when compared to other materials commonly used on the on the market today and have much lower tensile strength.

All components other than springs and the valve body assemblies are manufactured at our facility. All welding procedures are engineered and approved under a ASME standards in our ABSA approved welding facility

All our designs are rigorously reviewed through third party Engineering, FEA analyses, strict QC system, functional and validation tested.

Contact your local Definitive Optimization Team member and ask about our full lines of Smart Flow Lubricator systems. We have designed and built a full line of equipment from 1" to 5.5" tubing sizes. Our warehouse carries many 2 3/8" and 2 7/8" and 3" 1/2" in stock.

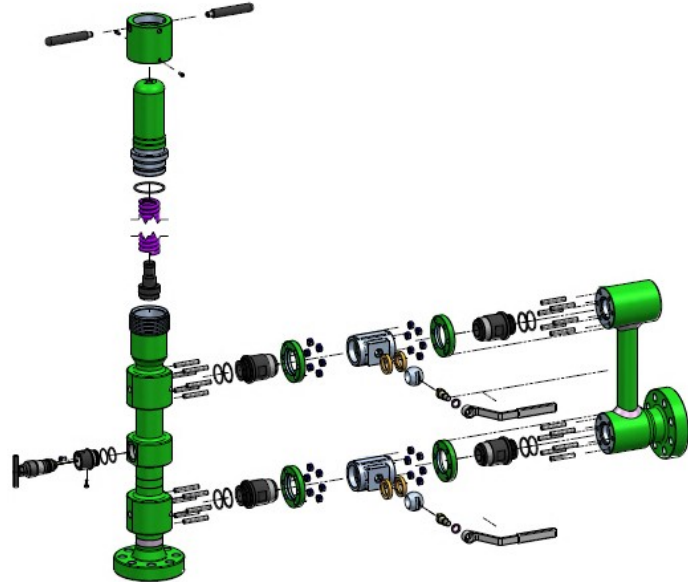

Sales (855)9DEFOPT (933-3678)

Definitive USA

Wyoming (307) 747-0015

Colorado (307) 274-5661

Texas/Oklahoma (254) 595-2123

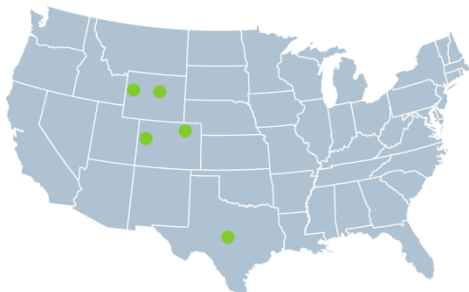

Definitive Canada

Calgary (587) 579-0355

